



WESTERN ALAMANCE HIGH SCHOOL

PROPOSED DESIGN

OCTOBER 13, 2020

PRESENTED BY:

PINNACLE ARCHITECTURE, P.A.



WESTERN HIGH SCHOOL BOND PROJECT SCOPE

Year Built: 1960

Existing Building area: 136,200 SF

Existing Classroom capacity: 1085 students

Number of students: 1,212 (2017-2018)
111.71 capacity

NEW ADDITION TO INCLUDE:

- Cafeteria/Dining Expansion
- 4 Classrooms
- 2 Classrooms Exceptional Children Program
- 2 Resource Room
- 1 Career/Technical Education lab
- Restrooms
- Renovations/upgrades to existing buildings

Renovate/Upgrade Existing Buildings to included:

- School safety improvements (cameras, blinds, carded entry locks)
- Flooring replacement remove/abate remaining asbestos tiles.
- Exterior window replacement and caulk where needed.
- Renovate multi-restroom facilities with new plumbing fixtures, tile, partitions and paint
- Roof replacement or repairs where needed
- Humidity controls/HVAC upgrades where needed
- Replace campus walkway canopy system
- Replace auditorium seating
- Replace non-ADA compliant cabinetry, sinks, door hardware
- Remove lockers to widen hallways for improved traffic flow
- Replace exterior sidewalks for better accessibility

Western Alamance High School

- Currently in early phase of Schematic Design
- Administrative Staff has provided input to determine building location, classroom needs, repurpose of space, etc.
- Campus study in progress. Once complete preliminary plans will be presented to the Alamance-Burlington Board of Education.

OVERALL SITE REFERENCE PLAN

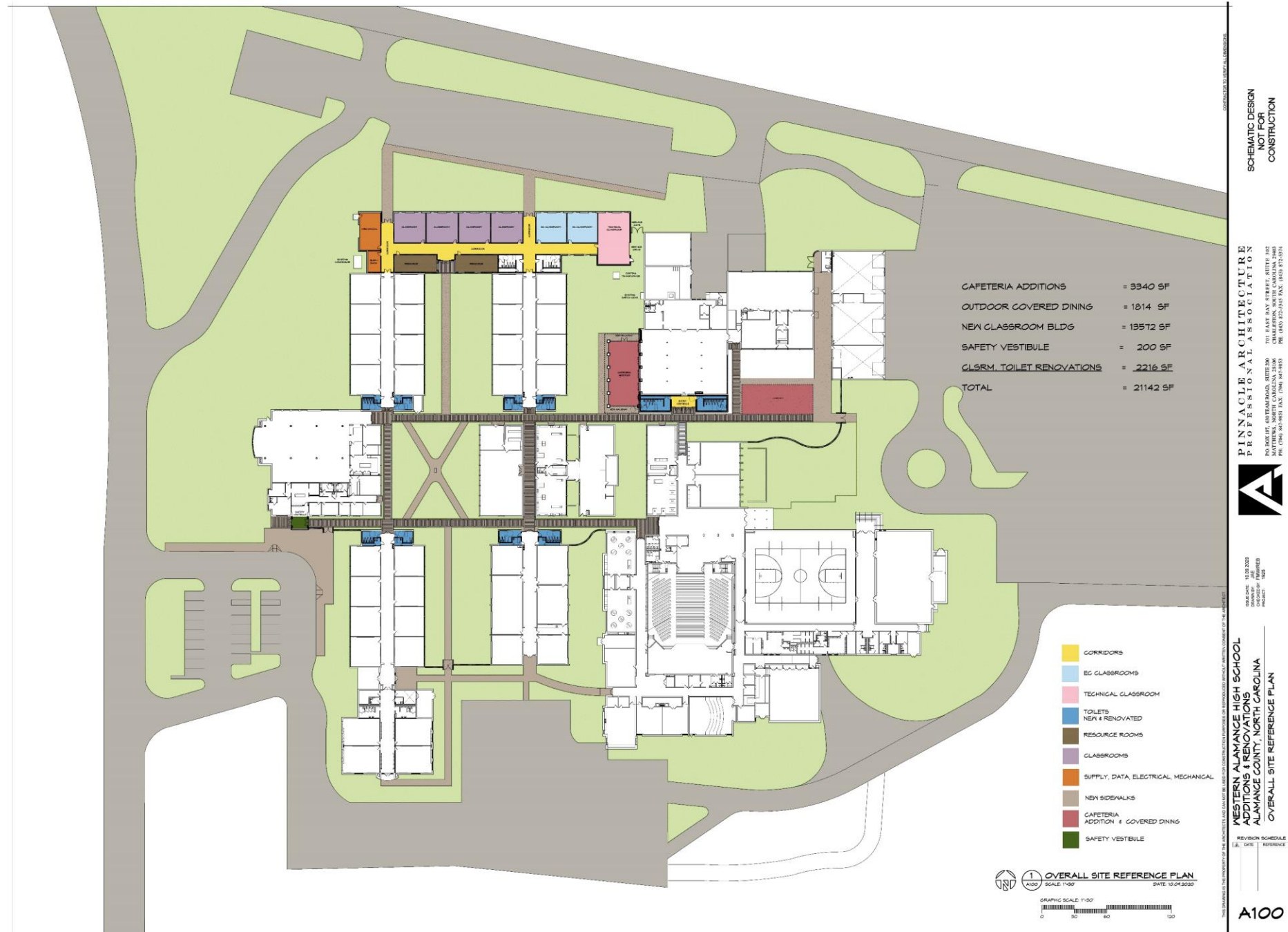



CAFETERIA PERSPECTIVE



TYPICAL CLASSROOM