

EASTERN ALAMANCE HIGH SCHOOL

PROPOSED DESIGN

OCTOBER 13, 2020

PRESENTED BY:

PINNACLE ARCHITECTURE, P.A.



EASTERN HIGH SCHOOL BOND PROJECT SCOPE

Year Built: 1961

Existing Building area: 158,626 SF

Existing Classroom capacity: 985 students

Number of students: 1,273 (2017-2018)

129.24% over capacity

NEW ADDITION TO INCLUDE:

- Cafeteria/Dining Expansion
- 4 Classrooms
- 2 Classrooms Exceptional Children Program
- 1 Resource Room

Renovate/Upgrade Existing Buildings to included:

- School safety improvements (cameras, blinds, carded entry locks)
- Exterior window replacement where needed
- Renovate multi-restroom facilities with new plumbing fixtures, tile, partitions and paint
- Roof replacement or repairs where needed
- Humidity controls/HVAC upgrades where needed
- Canopy replacement/repairs
- Replace auditorium seating
- Replace non-ADA compliant cabinetry, sinks, door hardware
- Remove lockers to widen hallways for improved traffic flow
- Grading work to correct eroding slopes
- Update switchboard/wiring

OVERALL SITE REFERENCE PLAN



SCHEMATIC FLOOR PLAN

- CORRIDORS
- ADMINISTRATIVE AREAS
- CLASSROOMS
- SUPPLY, DATA, ELECTRICAL
- TEACHER WORKROOM
- TOILETS

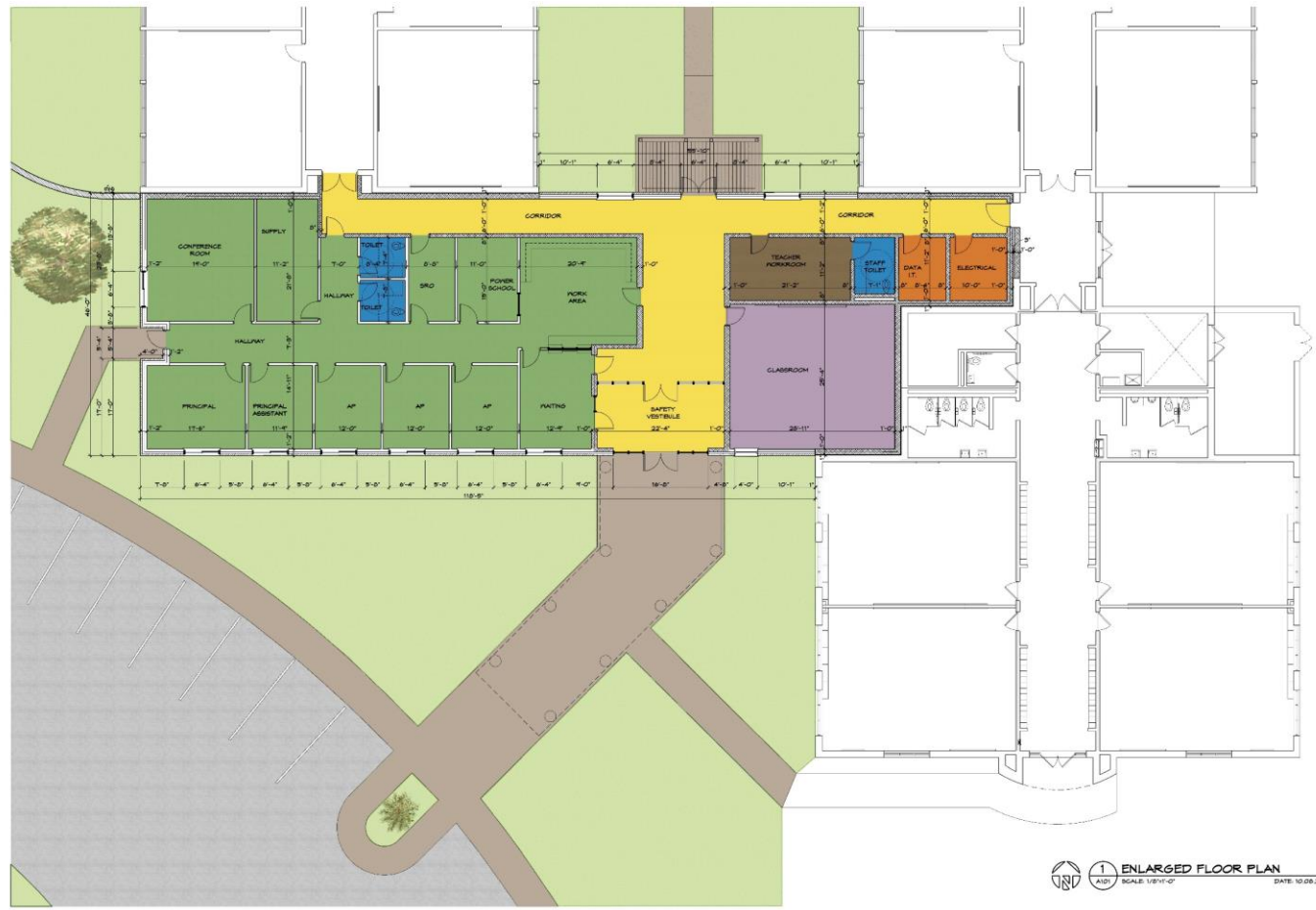

1 ENLARGED FLOOR PLAN
SCALE: 1/8"=1'-0"
DATE: 10.00.2020



2 FRONT ELEVATION
SCALE: 1/8"=1'-0"
DATE: 10.00.2020



TYPICAL SCIENCE ROOM



TYPICAL SCIENCE ROOM



TYPICAL CLASSROOM